



Dedicated to a higher standard.

Connect with Lovink



LoviSil[®] M Splices

LoviSil[®] M Medium Voltage transition splices are designed to meet the highest standards of electrical insulation ensuring a seamless transition from paper to polymeric cables.

lovink-enertech.com

LoviSil® medium voltage cable splices have been developed featuring liquid silicones. This patented extraordinary technology is backed by 30+ years of proven field experience with extremely high reliability rates. The construction and silicone based insulation material in the LoviSil® splice makes this splice particularly suitable for applications with polymeric and paper-insulated cables.

Reliable power distribution

The key component within the LoviSil® splices is liquid silicone, utilized to provide primary insulation, fill out any potentially damaging voids, and provide the ideal environment for other components. When used on PILC cable, liquid silicone has the same characteristics as cable grease, preventing the insulating paper tapes from drying out. When used on polymeric cables, the electrical properties of liquid silicone minimize the need for core-installed components and related installation tasks.

The splice delivers excellent mechanical protection through the combined use of polyurethane resin and high-specification, injection-molded outer shells.

This provides:

- Engineered to provide sustained mechanical and environmental protection in the harshest environments.
- Fully insulates the splice screen to ensure reliable sheath testing.

Cost savings

Our high-quality, reliable cable splices help reduce your Total Cost of Ownership (TCO) by reducing your splice failure rates and need for repairs. Additionally, our flexible modular system simplifies logistics by minimizing the inventory needed to support multiple cable types.

Easy installation

LoviSil® splicing system provides splicers with an easy, rapid and safe installation. Components are easily identified and installed in logical order. Furthermore, smart component design and transparent inner splice make installation easier and more splicer-friendly.

No soldering or heat-shrinking is required, reducing the need for tools and minimizing the risk of human error.

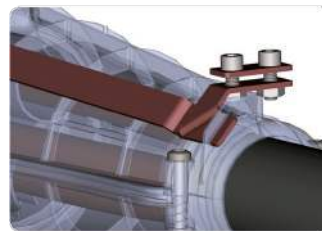

Pre-mounted parts



Transparent design enables easy visual inspection and fill verification

- Provides optimal insulation for all components within the splice.
- Exposure to water or humidity triggers the formation of an insulating rubber layer.
- Minimizes partial discharges.
- No carbon traces are produced under fault conditions.



LoviSil® M Splices

Successfully tested

LoviSil® cable splices are tested to meet the highest standards for electrical and mechanical performance. They comply with IEEE 404 and HD 629 (CENELEC) testing protocols and have been successfully tested under 29 psi water pressure.

Flexible installation options:

- Designed for manhole and direct buried applications.
- Compatible with paper- and polymer-insulated cables.



Application range

Maximum cable dimensions LoviSil® cable splices 15 kV					
Type	Cable	Conductor size AWG – MCM*	Conductor size (crossed)	Max. diameter outer sheath (inch)	Dimensions L x W (inches)
M75	Polymeric/paper (1-core)	4/0 – 1,000	NA	2.8	41.26 x 8.58
	Polymeric/paper (3-core)	1/0 – 250	1/0 – 4/0	2.8	
	Polymeric (3 x 1 core)	1/0 – 250	NA	1.3	
M85	Polymeric/paper (1-core)	1,250 – 1,750	NA	3.2	44.41 x 9.33
	Polymeric/paper (3-core)	1/0 – 400	1/0 – 350	3.2	
	Polymeric (3 x 1 core)	1/0 – 350	NA	1.5	
M105	Polymeric/paper (1-core)	1,250 – 2,000	NA	4.1	54.57 x 11.38
	Polymeric/paper (3-core)	1/0 – 600	1/0 – 500	4.1	
	Polymeric (3 x 1 core)	1/0 – 600	NA	1.9	

(*) Diameter of the overall / jacket diameter determines which cable fits in which splice size.

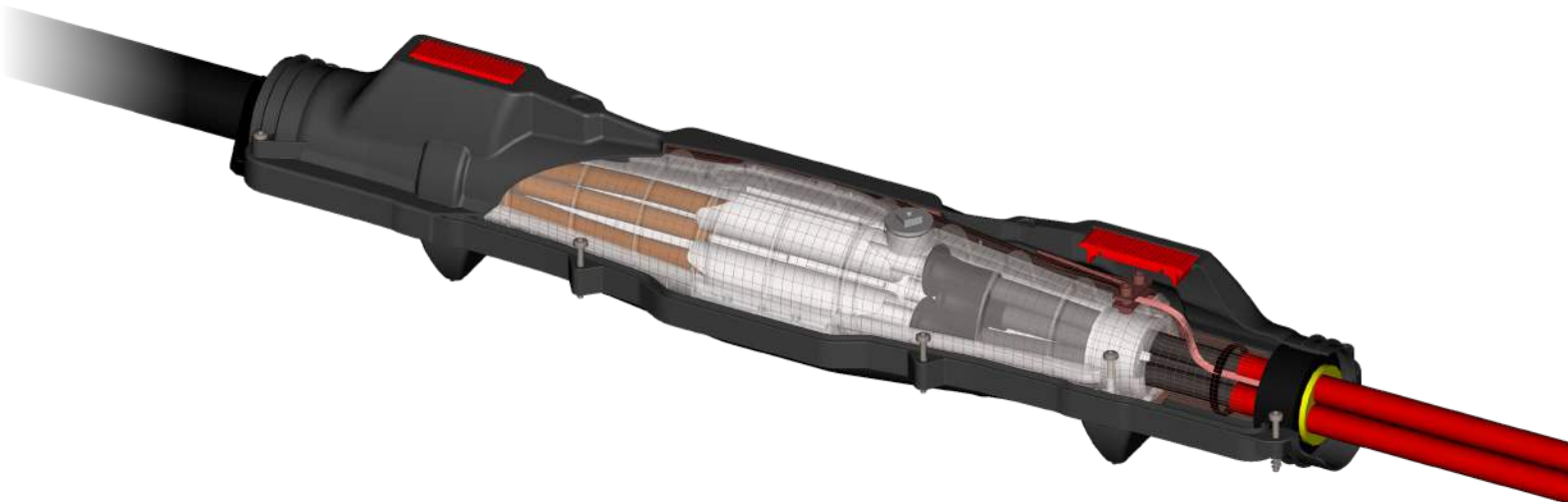



Our solutions don't just work. They work reliably, with precision and with purpose, because we know the power we provide fuels progress across the globe.

With over 100 years of expertise, Lovink delivers trusted, time-tested solutions. We focus exclusively on medium voltage underground splices, offering unmatched expertise and precision.

Our products are built to stand the test of time. Just like our partnerships. With end-to-end service, seamless supply, and a commitment to taking the pressure off your shoulders - we provide peace of mind. By choosing Lovink, you're partnering with a company that is dedicated to quality, reliability and innovation for over 100 years.

At Lovink, performance isn't just a promise, it's our foundation.

Lovink Enertech Inc.

228 East 45th Street

Suite 9E

New York, NY 10017

USA

T (347) 328-0629

I www.lovink-enertech.com

E info@lovink.com